

FAÇADE SYSTEM arcoPlus® VT

Created with polycarbonate panels linked together through connector joints, this system is equipped with a wide range of accessories to offer greater versatility in application. Brackets, flaps, seals, junction connectors, and frame profiles prevent water infiltration on flat, vertical surfaces no matter what the size. With the variety in treatments and colors, it is possible to customize the panel to any application need, making the VTfaçade system suitable for any design requirements.

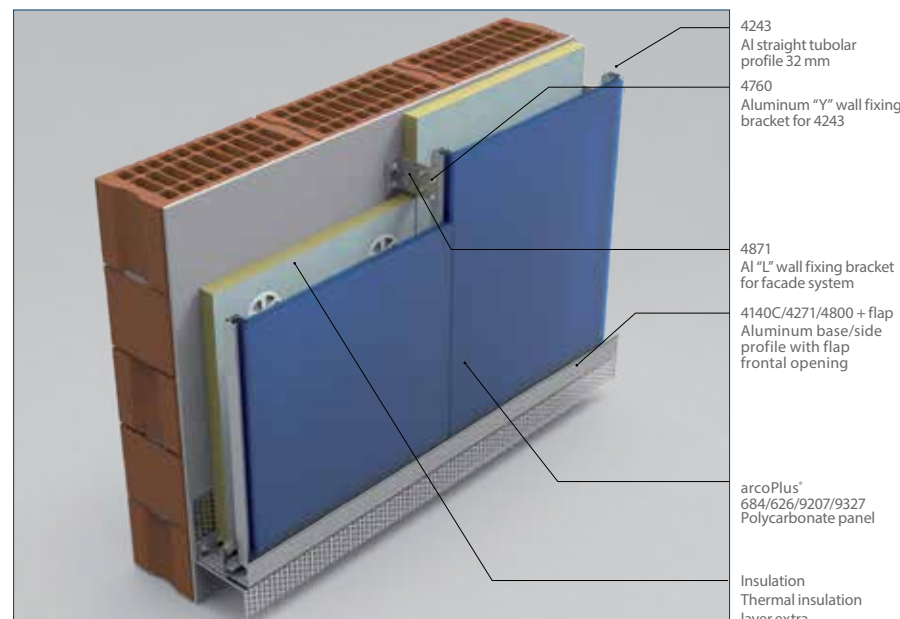

VENTILATED FAÇADE BENEFITS

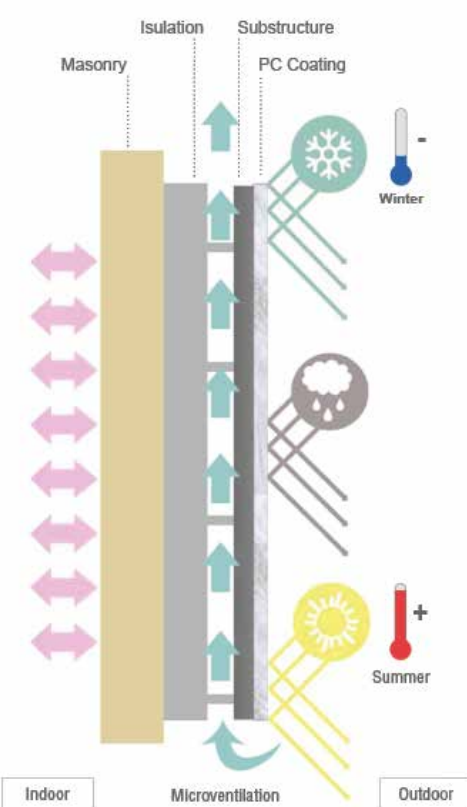

The Ventilated Facade System is an "intelligent" external envelope that optimizes the indoor environment and protects the building structure. The external cladding of polycarbonate mounted with enough space creates micro-ventilation, allowing moisture and thermal energy to escape easily with airflow. During summer months this system acts as a thermal shield, keeping inside temperatures constant and energy bills reduced. An additional insulation layer can be added between the inside cavity and the building structure during winter months. The Ventilated Facade is an alternative eco-sustainable solution for both new design projects and building redevelopment to increase aesthetic value.

● healthy indoor living spaces

- masonry imperfections hidden
- dry and healthy masonry walls
- natural air-ventilation
- indoor constant temperature
- more performing coating insulation
- water-repellent outer wall cladding
- climate/living comfort

SPECIAL TREATMENTS

AB ABSOLUTE AB-ABSOLUTE

Polycarbonate panels used for ventilated façades can be produced with the innovative AB-Absolute treatment. This treatment creates an opaque surface on the side of the panel facing the masonry while maintaining the transparent effect on the outside. Customized colors can be applied to the opaque or translucent surface.

UV TECH UV-TECH SOLAR EXPOSURE WARRANTY

arcoPlus® with UV-Tech Treatment is covered by an extended warranty up to 15 years. This is due to an improved UV coextrusion on the external side that is more chemically stable and effective over time. They guarantee greater protection against damage caused by extended solar radiation exposure.

AG ANTI-GRAT AG ANTI-SCRATCH & ANTI-GRAFFITI

For locations where polycarbonate panels are at risk for vandalism such as spray paint or surface scratching, AG-Anti-graffiti coating is the solution. AG is a coating applied to polycarbonate to create an anti-scratch and anti-graffiti surface to repel oil and water so that it cannot penetrate into the substrate allowing for easy removal.

CALEIDO PROJECT CALEIDO PROJECT

To meet architectural design requirements, the Caleido project was formed to focus on the creation of custom colors. This project made it possible to create an infinite range of color straying from the tradition few. These production capabilities help bring form to all architectural aspirations.

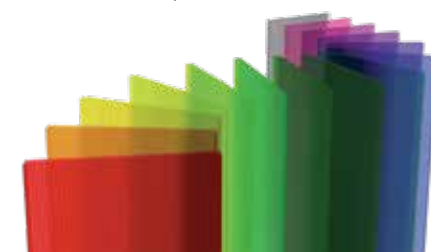

BC BICOLOR ONE PANEL | TWO COLORS

The arcoPlus® panels can be produced with two different color layers to ensure long-lasting external color retention. This product makes it possible to maintain a visual comfort with light diffusion in the indoor environment, while also having an attractive outdoor façade full of bright

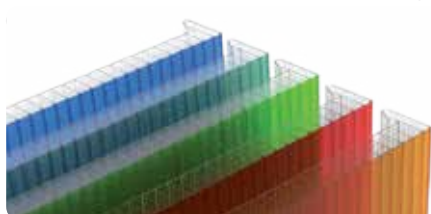

IR IR SOLAR CONTROL

IR treated panels can absorb portions of sun rays within infrared spectrum (780-1400nm), blocking out solar heat while bringing in light. This product can reduce the internal increase in temperature caused by the greenhouse effect by up to 25%, to help keep a comfortable indoor climate.

UV MATT UV-MATT ANTI-REFLECTIVE LIGHT DIFFUSION

UV matt is UV ray protection with a matt finish coextruded into the external surface of the panel. This coextrusion gives your project a non-reflective finish rather than the normal reflective surface you would have with transparent building envelopes. This process allows the diffusion of light through its surface, while getting rid of sun glares and reflections.



ED.ENG.08.18

AB ABSOLUTE AB-ABSOLUT TREATMENT

Polycarbonate panels, used for ventilated façades construction, can be produced using the innovative AB-Absolut coextrusion process. This treatment makes opaque the side panel facing the wall, maintaining the usual polycarbonate transparency on the external side. Furthermore, there is the possibility to realize the opaque coextrusion in different colors, according to the project creativity.

Important: data contained in this document is provided in good faith with promotional/sales goals and it can be changed without notice. For further details contact directly our staff by phone or write e-mail to info@gallina.it.

Strada Carignano 104 - 10040 La Loggia (Turin) Italy
tel. +39 011 962 81 77 - fax +39 011 962 83 61
info@gallina.it - www.gallina.it

dott.gallina
POLYCARBONATE SYSTEMS & SHEETS

arcoPlus®
VT facade

**Modular connector system
for multiwall polycarbonate**

LIVING COMFORT
Curtain wall cladding
Ventilated façade

dott.gallina
POLYCARBONATE SYSTEMS & SHEETS

Modular connector system composed of UV protected multiwall polycarbonate panels for façade installation and wall cladding

SPECIAL TREATMENTS



APPLICATIONS

- Curtain wall cladding
- Ventilated façade

CERTIFICATIONS



Document Technique d'Application n°2/13-1551 published on 14th 08/2013



© Tortasini Design Architecture, Grenoble

PRODUCTION STANDARDS

	684	626	9207	9327
Panel				
Thickness (mm)	8	20	20	32
Structure (walls)	4	6	7	7
Effective modular width (mm)	600	600	900	900

TECHNICAL FEATURES

Thermal transmittance U (W/m²K)	3,0	1,7	1,7	1,3
Linear thermal expansion	0,065 mm/m°C			
Temperature range	-40°C +120°C			
U.V. rays protection	Coextrusion			
Fire reaction EN 13501-1	EuroClass B-s1,d0			

DESCRIPTION

ArcoPlus®VT is a modular system specially designed for façade cladding and ventilated façades. It can be composed of four different types of modular multiwall polycarbonate panels 8, 20, or 32mm thick and 60 or 90 cm wide. The system is also equipped with both aluminum frame profiles and polycarbonate corner profiles to create a secure protective envelope for all kinds of buildings.

LOAD RESISTANCE

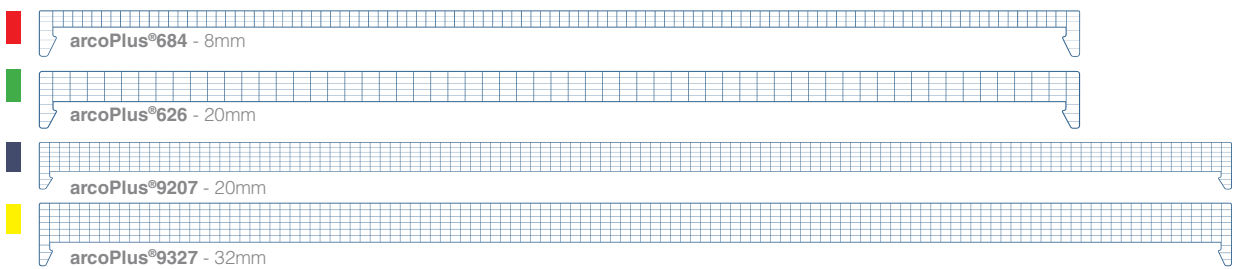
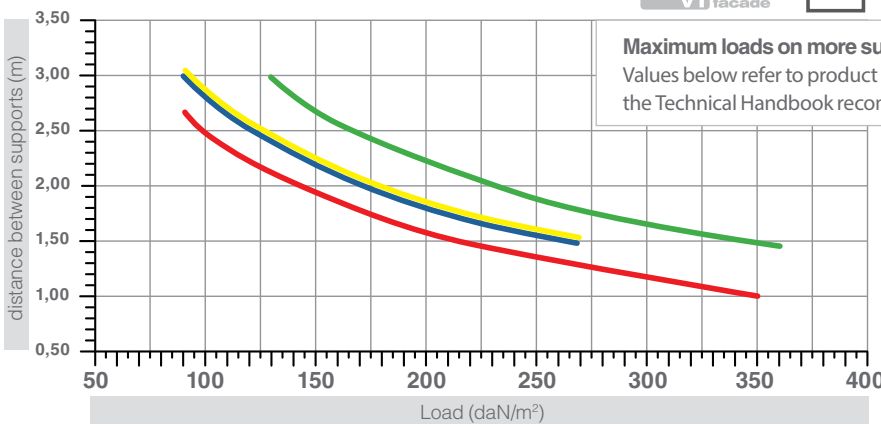

INSTALLATION DETAILS



JUNCTION OF ADJACENT PANELS
Paneling fixes(connects) to the masonry wall and secures to fit insulation material and allow air-circulation

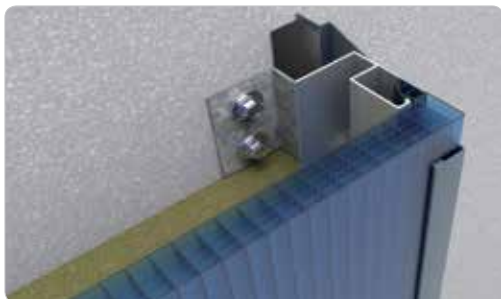

CLOSURE OF CLADDING SIDE
Suitable for fixing (connecting) the paneling and side-ending with Al terminal profile



SEAMLESS CONTINUITY FOR WALL-CORNERS
Polycarbonate corner profile fixed (fixes) to the appropriate anchored aluminum profile at wall corner



DETAIL OF CLADDING BASE INSTALLING
Installation of profile 4271 creates a façade base-support using 20mm thick panels

ALLUMINUM PROFILES

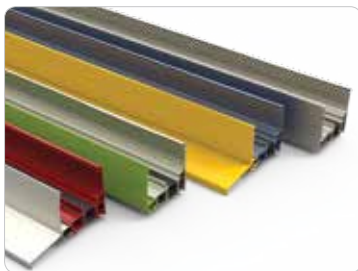

PROFILS WITH DIFFERENT COLORS
Diversify the color between the inner and outer side of wall paneling

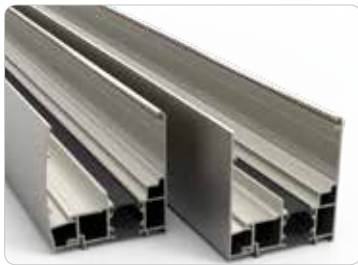

DIFFERENT TYPES OF FACE FLAP
Curved and straight shapes

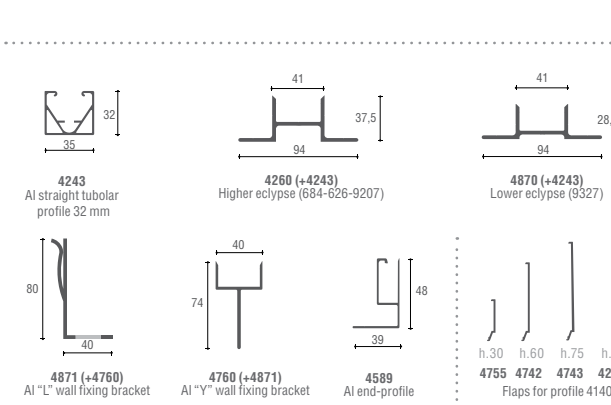
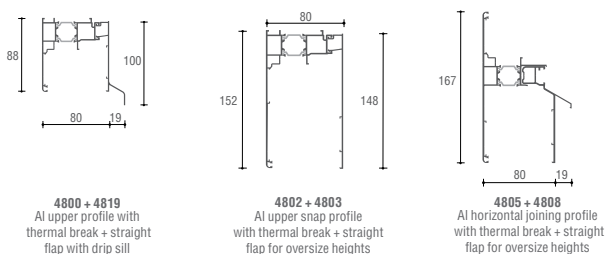

ACCESSORIES

	2147 th.8 mm 2179 th.20 mm 2710 th.32 mm PC starter profile		4802+4803 th.32 mm Al upper snap profile with TB for oversize heights with special straight flap for 9327 panel
	2148 th.8 mm 2180 th.20 mm 2712 th.32 mm PC terminal profile		4805+4808 th.32 mm Al horizontal joining profile with TB for oversize heights with straight drip sill flap for 9327 panel
	4589 Al end profile		4140/C (+flap) th.8 mm Al base/side snap profile for th.8 mm
	2550 PC corner 90° cover profile		4899 th.32 mm Al rear pad
	4588/4738 th.20 mm 4740 th.32 mm Al corner profile (+2550)		4760 Al "Y" wall fixing bracket for connector 32 mm (+4243+4871)
	4243 Al connector profile 32 mm (straight)		4871 Al "L" wall fixing bracket for facade system (+4760)
	4271 th.20 mm Al base/side profile including flap 4140/B		4260 Higher eclipse +4243 (684-626-9207) 4870 Lower eclipse +4243 (9327)
	4800 (+flap) th.32 mm Al base/side/upper profile with TB		1169/B Slip-coat rubber seal strip
	4755 - h.30 4742 - h.60 4743 - h.75 4275 - h.100 Al flaps (30,60,75,100 mm)		1169/B/AGS Overlap Slip-coat seal strip
	4809 (+4800) Al base/upper/side straight flap		4213 size 40x35x580 4465 size 50x35x875 LPDE foam pad
	4831 (+4800) Al base straight flap with drip sill		4970/600 - th.8 mm 4974/600 - th.20 mm Al closing edge strip drip-free
	4819 (+4800) Al upper straight flap with drip sill		4974/900 th.20 mm 4976/900 th.32 mm Al closing edge strip drip-free
	4801 (+4800) Al upper curved flap with drip sill		1372 Internal PE base dripping eave (+4800)
	4804 (+4800) Al base/upper/side curved flap		4828 Flat plain aligner
	4807 (+4800) Al base curved flap with drip sill		4327/4950 Taping surcharge